



Recycled Content:
25%

SILHOUETTE® XL® 1/4" Reveal 9/16" Bolt-Slot Systems

Silhouette XL 1/4" Reveal 9/16" Bolt-Slot Systems provide a crisp reveal with a clean-cut miter intersection and simplified partition attachment.

Key Selection Attributes

- **Seismic Rx®** Suspension System saves time and money; Armstrong has an ICC-ES approach to installations (ESR-1308)
- **PeakForm®** profile increases strength and stability for improved performance during installation
- Painted double web hot dipped galvanized steel provides superior corrosion resistance versus painted only systems
- Rotary stitching for greater torsional strength, stability and tight miter conditions at all perimeter cuts
- 1/8" reveal also available
- Installs virtually flush with ceiling panel surface for monolithic appearance
- XL (staked-on end detail) cross tees provide secure locked connection; easy to remove, reuse and relocate
- 10-year limited warranty; 30-year with **HumiGuard® Plus** products



Typical Applications

- Offices
- Retail
- Hospitality
- Schools

Product Description

Materials

A. General:

ASTM C635 (Intermediate-duty) (Heavy-duty) main beam classification, commercial-quality hot dipped galvanized steel. Entire surface chemically cleansed and prefinished in baked polyester paint.

B. Components:

1. Main Beams: Rotary stitched double-web construction, profile height 1-3/4" with rectangular top bulb and 9/16" mitered flange with regressed center slot that accepts a 1/4" T-bolt.

- 7600 (144", routs 12" OC, notched 24" OC, Intermediate-duty)
- 7601 (144", routs 12" OC, notched 24" OC, Heavy-duty)
- 7602 (120", routs 12" OC, notched 24" OC, Intermediate-duty)
- 7603 (144", routs 12" OC, notched 48" OC Intermediate duty)
- 7606 (120", routs 15" OC, notched 30" OC, Intermediate-duty)
- 7612 (144", routs 12" OC, unnotched)

a. Metric Equivalent

- 804042 (3600 mm, routs 300 mm OC, notched 600 mm OC, Intermediate duty)
- Other _____

2. Cross Tees: Double-web construction, profile height 1-3/4" with peaked roof bulb and 9/16" mitered flange with regressed center slot that accepts a 1/4" T-bolt. Staked-on end detail allows cross tee removal. Double rotary stitched for cross tee stability and tight miter condition at all perimeter cuts.

- XL7610 (12", unnotched)
- XL7620 (24", unnotched)
- XL7670 (30", unnotched)
- XL7640 (48", unnotched)
- XL7645 (48", center-notched both sides)
- XL7646 (48", center-notched one side)
- XL7650 (60", unnotched)
- XL7655 (60", center notched both sides)
- XL7690 (72", unnotched)
- XL7680 (96", unnotched)

a. Metric Equivalent

- 802042 (600 mm, unnotched)
- 803042 (1200 mm, center notched both sides)
- Other _____

3. Wall moldings: Hemmed (angle molding) (shadow molding), with prefinished exposed flanges.

- 7800 (144", nominal 7/8" x 7/8" hemmed angle molding)
- 7804 (144", nominal 9/16" x 7/8" hemmed angle molding)
- 7873 (120", nominal 9/16" x 15/16" shadow molding, 3/8" reveal)

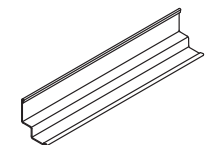
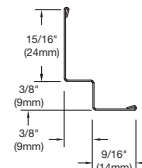
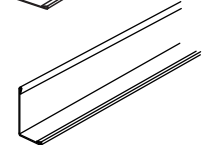
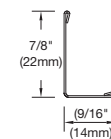
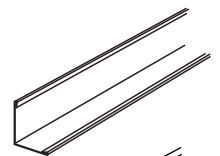
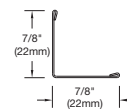
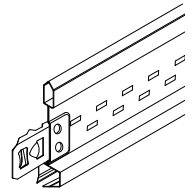
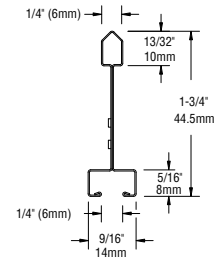
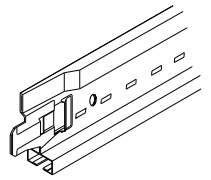



SILHOUETTE® XL® 1/4" Reveal 9/16" Bolt-Slot Systems



Physical Data

Material

Double-web hot dipped galvanized steel

Surface Finish

Baked polyester paint

Face Dimension

9/16"

Profile

Bolt-slot

Cross Tee/Main Beam Interface

Mitered

End Detail

Main Beam: Coupling

Cross Tee: Staked-on clip

Main Beam Load Test Data

MAIN BEAMS	LENGTH	WEB HEIGHT	ASTM CLASS	HANGER SPACING (Lbs/LF Simple Span)**	
				4'	5'
7600/804042	144"	1-3/4"	Intermediate-duty	13.1	6.61
7601	144"	1-3/4"	Heavy-duty	16.35	7.8
7602	120"	1-3/4"	Intermediate-duty	13.1	6.61
7603	144"	1-3/4"	Intermediate-duty	13.1	6.61
7606	120"	1-3/4"	Intermediate-duty	13.1	6.61
7612	144"	1-3/4"	Heavy-duty	16.35	7.8

Cross Tee Load Test Data

CROSS TEES	LENGTH	WEB HEIGHT	HANGER SPACING (Lbs/LF Simple Span)**	
			4'	5'
XL7610	12"	1-3/4"	69.69	
XL7620/802042	24"	1-3/4"	69.69	
XL7670	30"	1-3/4"	39.86	
XL7640	48"	1-3/4"	13.53	
XL7646	48"	1-3/4"	13.01	
XL7645/803042	48"	1-3/4"	12.0	
XL7650	60"	1-3/4"		9.0
XL7655	60"	1-3/4"		7.0
XL7690	72"	1-3/4"	12.59	
XL7680	96"	1-3/4"	12.59	

Seismic Performance

MAIN BEAMS	MINIMUM LBS. TO PULL OUT COMPRESSION/TENSION
7600/804042, 7606, 7602	340.0
7601	392.9
7603	340.0

CROSS TEES	MINIMUM LBS. TO PULL OUT COMPRESSION/TENSION
XL7610	299.5
XL7620/802042	
XL7640	
XL7645/803042	
XL7646	
XL7650	
XL7670	
XL7655	
XL7680	
XL7690	

ICC Reports

For areas under ICC jurisdiction, see ICC evaluation report number ESR-1308 for allowable values and/or conditions of use concerning the suspension system components listed on this page. The report is subject to reexamination, revisions and possible cancellation.

**To derive maximum lbs/SF, divide the on-center spacing of the component into the lbs/LF given in the load test data table.

Finishes

- WH - White
- BL - Black Reveal

NOTE: Items 7600, XL7640, XL7645, XL7620 are available in black reveal.

NOTE: Color chips included with samples of Armstrong grid. See your Armstrong representative for sample material.

Product Description (cont'd)

4. Fixture Clip: Prefinished clip for use at corners of light fixture modules.
5. Partition Clip: Fastens partition top section to grid for secure, seismic-rated attachment.
6. Silhouette 1/4" Reveal Miter Closure Clip: Eliminates main beam and cross tee miters.

- LFC
- Other

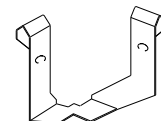

- UPC
- Other

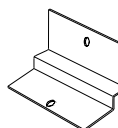

- MCC4

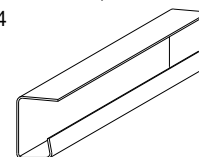

Maximum Fixture Weight

A. Main Beam to Main Beam

Main Beam ↑
Hanger Wire (•)

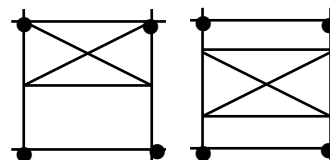

1. Fixture*
2. Planning Module
3. Hanger Spacing
4. Item 7600/7602
4. Item 7601

24" x 48"
48" x 48"
48"
73.0 lbs.
76.0 lbs.

24" x 48"
48" x 48"
48"
73.0 lbs.
76.0 lbs.

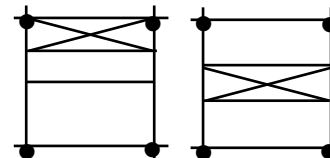

12" x 48"
48" x 48"
48"
73.0 lbs.
76.0 lbs.

12" x 48"
48" x 48"
48"
58.0 lbs.
76.0 lbs.

Main beams tested as follows: 7600 tested at 13.1 lbs/LF to 1/360 of 4' span; 7601 tested at 16.35 lbs/LF to 1/360 of 4' span.

B. Cross Tee to Cross Tee

Main Beam ↑
Hanger Wire (•)

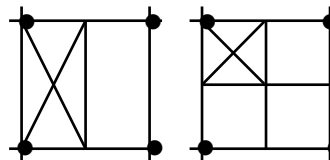

1. Fixture*
2. Planning Module
3. Hanger Spacing
4. Item XL7645
- Item XL7646

24" x 48"
48" x 48"
48"
59.0 lbs.
59.0 lbs.

24" x 24"
48" x 48"
48"
41.0 lbs.
41.0 lbs.

48" cross tee tested as follows: XL7645 tested at 12.0 lbs/LF to 1/360 of 4' span.

NOTE: The above data is based on 48" hanger wire spacing, board weight of 1 lb/SF, maximum deflection of tees not to exceed 1/360 of the span, and suspension system installed in accordance with ASTM C636.

Fixture weight is based on single fixture only. For end-to-end fixtures or other configurations not shown, consult your Armstrong representative.

*Fixtures weighing more than 56 lbs. should be independently supported. Light fixture clips are required at all fixture locations.